

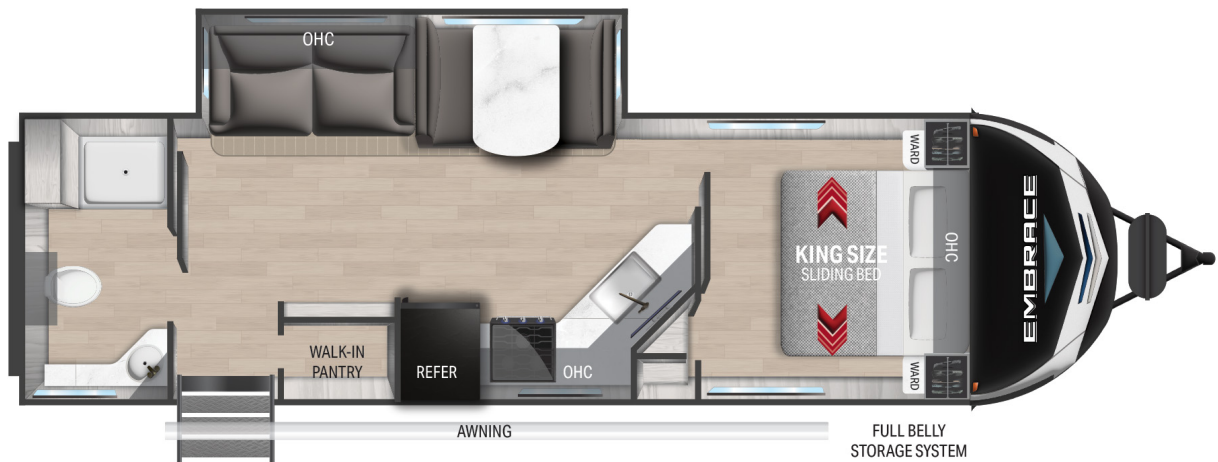

# EMBRACE



## Top Selling Features

- 6'11" Aluminum Roof
- 14.5k A/C Standard and 2nd A/C Prep
- 15" Rims and Tires on Heavy Duty Axles
- Laminated Rear Wall and Slide Out Ends
- Power Awning with LED Lights
- 72"x80" Patent Pending King Bed Slide System
- Solid Surface Countertops
- Tri Fold Sofa
- 5/8" Tongue and Groove Plywood Flooring
- Under Belly Storage

## Embrace EL250

GWVR	9,580 Lbs
Dry Weight	6,080 Lbs
Hitch Weight	780 Lbs
Axles	2 x 4400
Fresh Tank	44 Gal
Black Tank	30 Gal
Water Heater	6 Gal
Furnace	30,000 BTU
Air Conditioner	14,500 BTU
Number of Slides	1
Bedroom Height	6'-10-1/2"
Awning Length	20'
Cook Top	3 Burner
Traditional Oven	Yes
Convection Oven	No
Generator Prep	N/A
Sleep Capacity	5-6 People

\*Overall length defined as tow point (ball coupler for travel trailers / king pin for fifth wheel trailers) to rear bumper. It does not include rear ladder or spare tire. Optional pin boxes will affect overall length. \*\*Garage length is defined as ramp door to full interior wall. Standard or optional equipment may reduce overall garage dimensions. Information provided is accurate as of 3/3/2021 and is subject to update & change. Please confirm with your local Cruiser Dealership for up to date information.



[www.cruiservv.com](http://www.cruiservv.com)

Cruiser RV, LLC  
7805 North SR 9 • Howe, IN 46746  
260-562-3500