

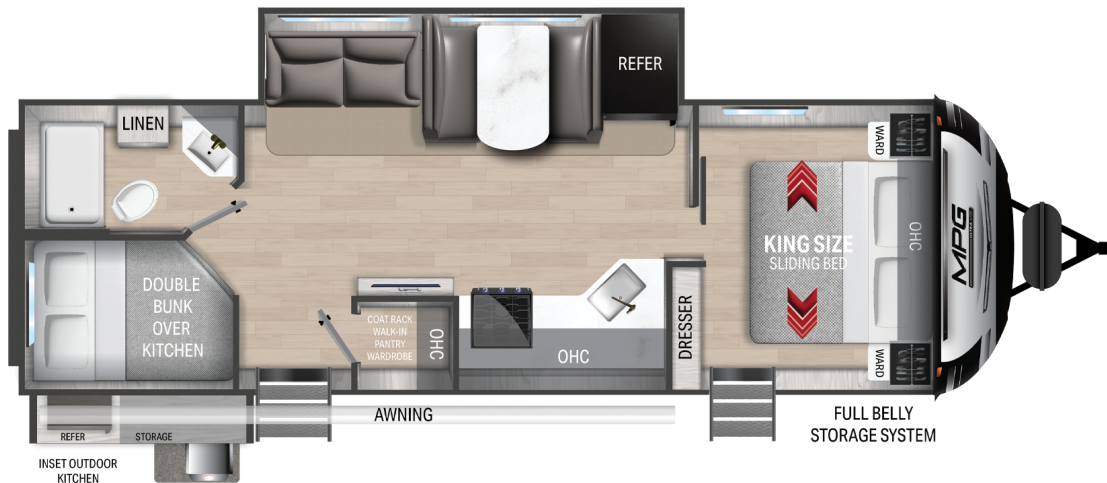

MPG



Top Selling Features

- Patent Pending King Bed Slide System
- Plywood Flooring
- Four Speaker Sound-bar System
- Seamless Kitchen Countertops
- Hardwood Residential Cabinets with Hidden Hinge
- Azdel Composite Laminated Walls
- 6' 11" Barrel Roof
- Fully Molded, Fiberglass Cap
- 5-Sided Aluminum Construction

MPG 2860BH

GVWR	9,600 Lbs
Dry Weight	6,724 Lbs
Hitch Weight	860 Lbs
Axles	2 x 4400
Fresh Tank	44 Gal
Black Tank	30 Gal
Water Heater	6 Gal
Furnace	30,000 BTU
Air Conditioner	15,000 BTU
Number of Slides	1
Bedroom Height	6'-10-1/2"
Length	32'-11"
Awning Length	20'
Cook Top	3 Burner
Traditional Oven	Yes
Convection Oven	No
Sleep Capacity	7-8 People

*Overall length defined as tow point (ball coupler for travel trailers / king pin for fifth wheel trailers) to rear bumper. It does not include rear ladder or spare tire. Optional pin boxes will affect overall length. **Garage length is defined as ramp door to full interior wall. Standard or optional equipment may reduce overall garage dimensions. Information provided is accurate as of 3/3/2021 and is subject to update & change. Please confirm with your local Cruiser Dealership for up to date information.



www.cruiserrv.com

Cruiser RV, LLC
7805 North SR 9 • Howe, IN 46746
260-562-3500