

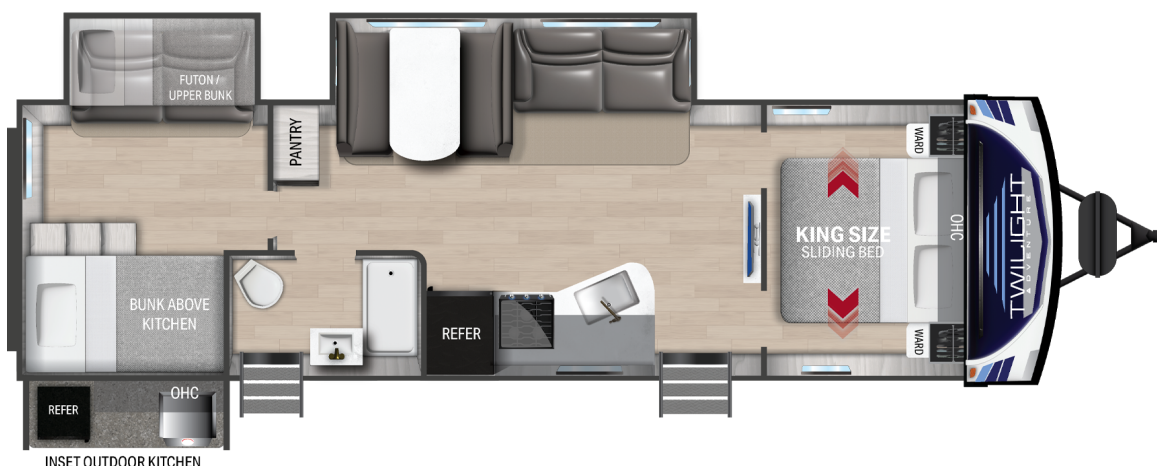

# TWILIGHT SIGNATURE



## Top Selling Features

- Whole RV Protection - 15K BTU High-Performance AC w/ Heat Pump, Dual Ducted AC System, Insulated Holding Tanks w/ Forced Heat Protection
- Serenity Suite - King Bed, Black-Out Roller Shades, Adjustable Reading Lights w/ USB Charging Ports
- Safety First Package - High End Tires w/ Aluminum Rims and Heavy-duty axles, Detachable ladder prep for roof, Power Tongue Jack and Stabilizer Jacks
- Twilight Elite Comfort - Residential Tri-Fold Sofa, Porcelain Toilet, Large LED TV, Bluetooth Stereo
- Chef Tech Residential Kitchen - Solid Surface Kitchen Countertops, 10 cu. Ft. Stainless Steel Refrigerator, Air Fryer Oven, Upgraded Microwave Oven and Range Hood, High-Rise Faucet w/ Pull-out Sprayer

## Twilight Signature 31BH

GWVR	9,722 Lbs
Dry Weight	7,480 Lbs
Hitch Weight	922 Lbs
Axles	2 x 4400
Fresh Tank	46 Gal
Black Tank	30 Gal
Water Heater	6 Gal
Furnace	30,000 BTU
Air Conditioner	15,000 BTU
Number of Slides	2
Bedroom Height	6'-10-1/2"
Length	36'-5"
Awning Length	19'
Cook Top	3 Burner
Traditional Oven	Yes
Convection Oven	No
Sleep Capacity	9+ People

\*Overall length defined as tow point (ball coupler for travel trailers / king pin for fifth wheel trailers) to rear bumper. It does not include rear ladder or spare tire. Optional pin boxes will affect overall length. \*\*Garage length is defined as ramp door to full interior wall. Standard or optional equipment may reduce overall garage dimensions. Information provided is accurate as of 3/3/2021 and is subject to update & change. Please confirm with your local Cruiser Dealership for up to date information.



[www.cruiserrv.com](http://www.cruiserrv.com)

Cruiser RV, LLC  
7805 North SR 9 • Howe, IN 46746  
260-562-3500